

I-3000

THIS DRAWING AND ALL DATA INCLUDED IS THE PROPERTY OF APPLIED SCIENTIFIC INSTRUMENTATION AND THE INFORMATION CONTAINED HEREIN IS FOR GENERAL PRESENTATION PURPOSES ONLY AND MAY CHANGE AT ANY TIME. CONTACT ASI OR A FACTORY REPRESENTATIVE FOR PROJECT SPECIFIC ENGINEERING.

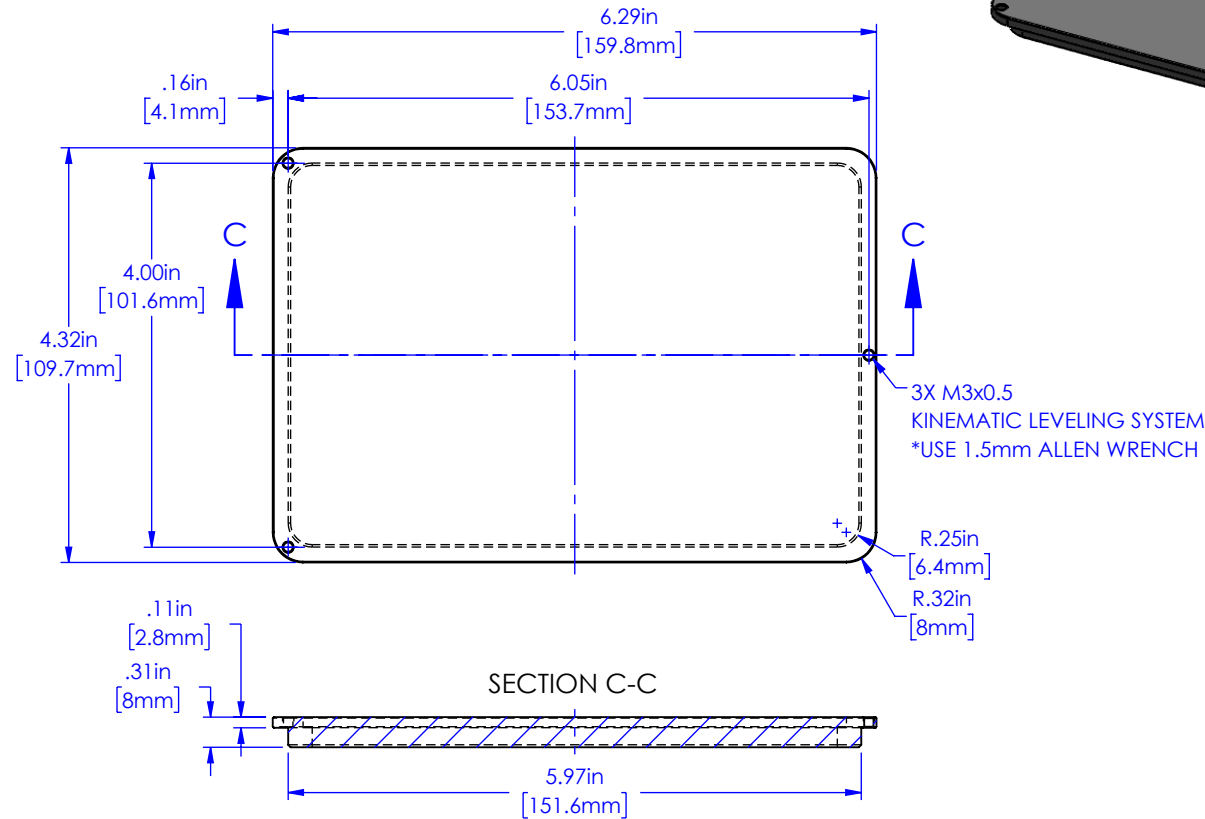
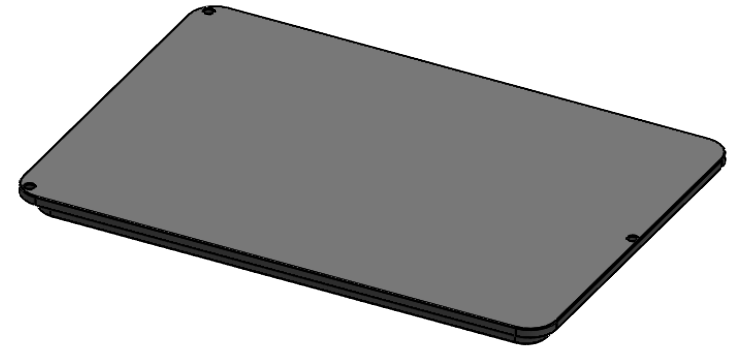

NOTES:

- 1) The I-3000 solid top insert provides a solid baseplate that can be modified by the user to meet their particular application needs.
 - 2) If you do not need a through-hole in the stage and just want a solid top stage, please order the stage itself with a solid top plate.
- We have solid top plates for all of our stages, including breadboard versions with either 1/4 - 20 threaded holes on 1 inch centers or M6 threaded holes on 25 mm centers.



PROPRIETARY AND CONFIDENTIAL
 THE INFORMATION CONTAINED IN THIS DRAWING IS THE SOLE PROPERTY OF APPLIED SCIENTIFIC INSTRUMENTATION. ANY REPRODUCTION IN PART OR AS A WHOLE WITHOUT THE WRITTEN PERMISSION OF APPLIED SCIENTIFIC INSTRUMENTATION IS PROHIBITED.

APPLIED SCIENTIFIC INSTRUMENTATION
 29391 W ENID RD
 EUGENE, OR 97402-9533
 PHONE: (541)461-8181
 FAX: (541)461-4018

UNLESS OTHERWISE SPECIFIED
 DIMENSIONS ARE IN INCHES
 .xx ± .01
 .xxx ± .005
 .xxxx ± .0002
 FRACTIONS ± 1/32
 ANGLES ± 1°

DESCRIPTION

SOLID PLATE INSERT

DRAWN BY/DATE

M.ANTHONY 11/27/23

CHECKED BY/DATE

V.MARSO 11/27/23

SCALE

1:2

REV

-

MATERIAL

MIC-6,
 ANODIZED BLK

DRAWING #

I-3000